

Solution guide: WLAN dongle connect to the router have an alarm of “Failed to scan the WiFi list!”

【Problem Description】

02312DHF function module, inverter external WLAN Dongle, have an alarm of “Failed to scan the WiFi list!” when click the WLAN drop-down list;

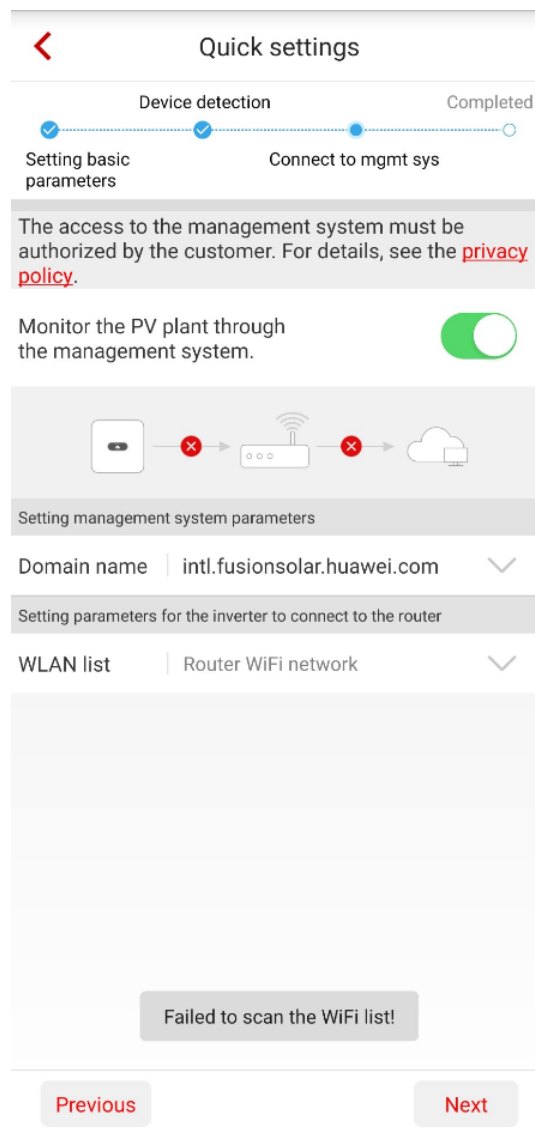

【Solution】

Method 1:

Step 1: When the “Failed to scan the WiFi list!” appears, hold the App keep the page displayed, unplug the WLAN dongle. After the LED is off, plug it back in the USB port.

Step 2: Wait for the WLAN dongle's LED turn to blink at short intervals (on for 0.2s and then off for 0.2s)

Step 3: In the App, click the WLAN list drop-down menu and select the WiFi name you want to connect to. (Only one chance)

Step 4: If the selection is not correct in step 3, please repeat steps 1~3;

Method 2:

Step 1: When the “Failed to scan the WiFi list!” appears, go to the “Communication configuration”-->“Router connecting settings” page;

Step 2: Click the WLAN list input box, tap the WiFi name and password in manual. Click the “Connect” button.

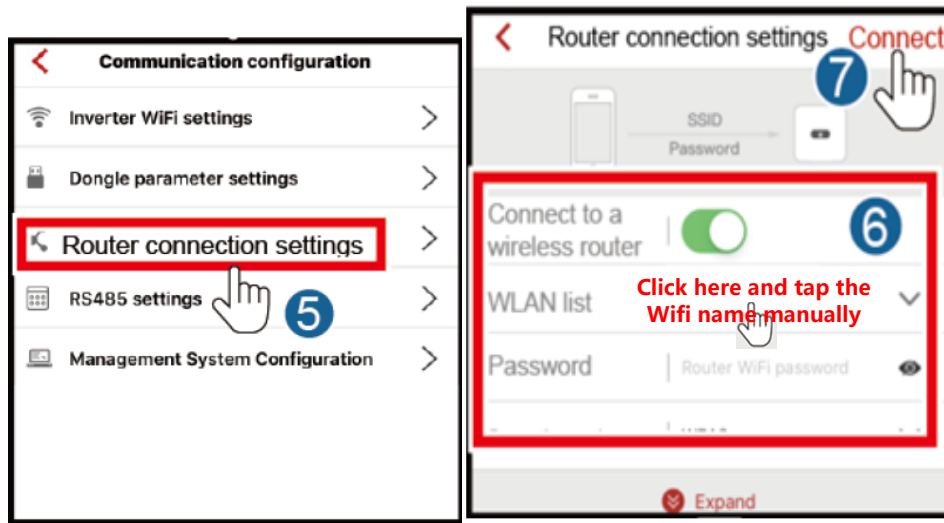

Step 3: re-do the quick setting.

Method 3:

Please contact to the Service team, obtain the SPC107 software version of the inverter, and then re-do the quick setting.

Fusionsolar App 2.3.7 version will release at 2019/10/27, this version will integrate the SUN2000MA SPC107 and suggest to upgrade.

WLAN dongle连接路由器时提示扫描路由列表失败解决方法指引

【问题描述】

02312DHF功能模块, 逆变器外置WLAN Dongle, 点击WLAN list下拉菜单时, 提示“扫描路由列表失败”。

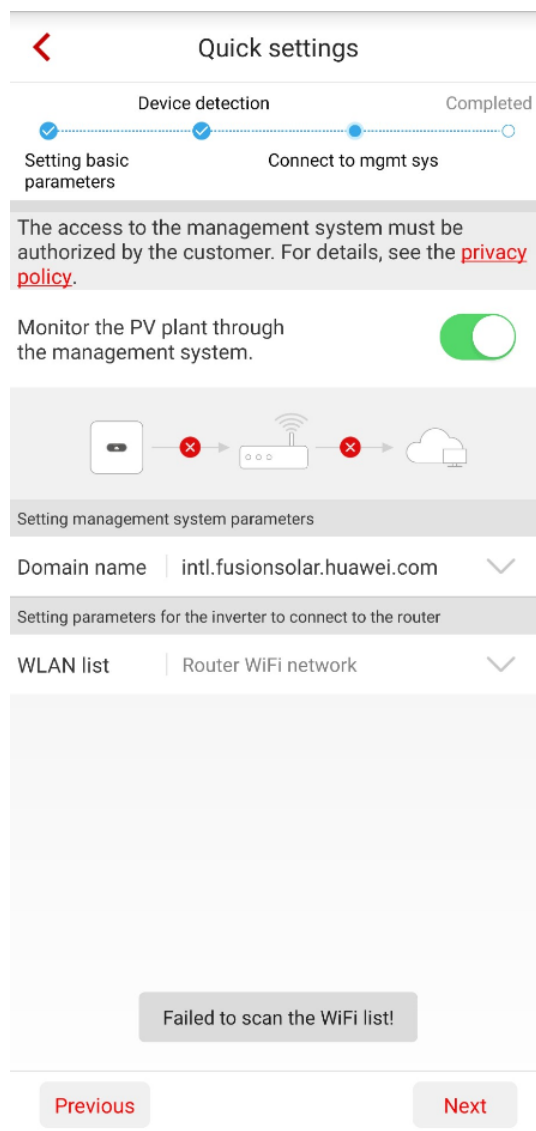

【解决方案】

方法1:

步骤1: 当出现 “Failed to scan the WiFi list!” 提示时, 请将WLAN dongle拔下, 待 Dongle LED灯灭, 重新插回USB接口;

步骤2: 等待WLAN dongle LED灯变成红灯快闪 (0.2s亮, 0.2s灭) ;

步骤3: 重新进行一键开局, 进入 “connect to mgmt sys”页面, 点击WLAN list下拉菜单, 选择需要连接的WIFI名称。(只有一次机会) ;

步骤4: 若在步骤3未选择正确, 请重新进行步骤1~3;

方法2:

步骤1: 当出现 “Failed to scan the WiFi list!” 提示时, 进入通讯设置->路由连接设置界面;

步骤2: 点击WLAN列表输入框, 手动输入WIFI名和密码, 点击连接;

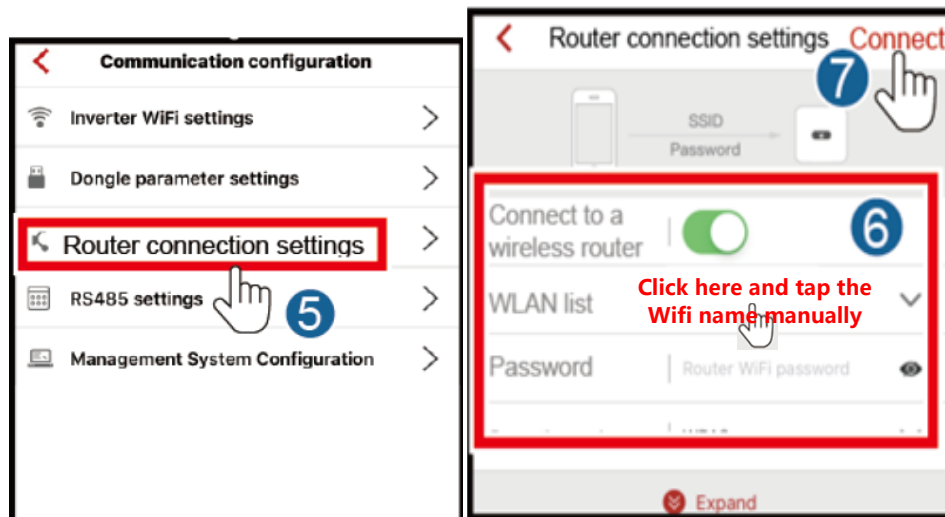

步骤3: 重新进行一键开局;

方法3:



联系客服，获取SUN2000MA SPC107软件版本，对逆变器升级后重新进行一键开局；

Fusionsolar App 2.3.7版本将于2019/10/27发布，将内置SUN2000MA SPC107软件版

本并建议客户升级；